

# FCG SERIES-GENERAL PURPOSE GEL BATTERY

## FCG12-100

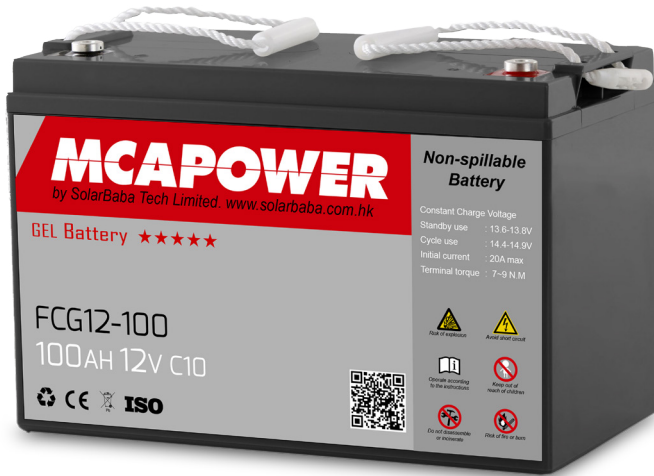

12V100AH C10

GEL technology

Low self-discharge

Maintenance - free operation

CHARGING AND DISCHARGING CHARACTERISTICS:

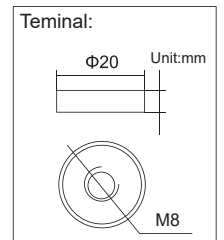
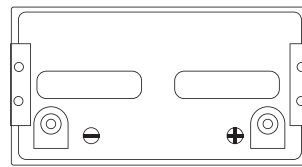
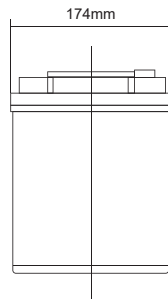
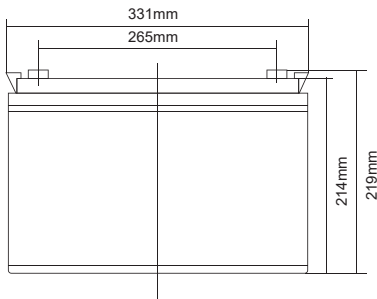
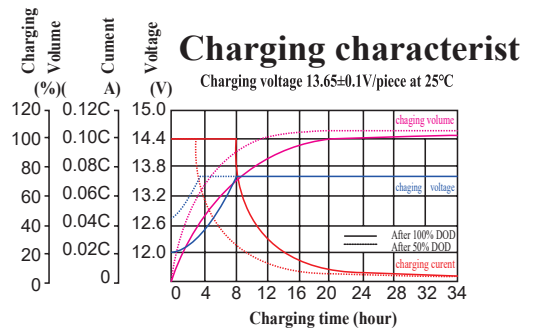

### TECHNICAL SPECIFICATIONS

<b>Nominal Voltage</b>		<b>12V</b>
<b>Nominal Capacity (10 hour rate)</b>		<b>100Ah</b>
<b>Capacity 25°C (77 °F)</b>	<b>10 hour rate (5.55A)</b> <b>5 hour rate (18.3A)</b> <b>1 hour rate (66.5A)</b>	<b>111.0Ah</b> <b>91.5Ah</b> <b>66.5Ah</b>
<b>Internal Resistance</b>	<b>Full Charged Battery 25°C</b>	<b>≤5.0mΩ</b>
<b>Capacity affected by Temperature (10 hr Capacity)</b>	<b>40°C (104 °F)</b> <b>25°C (77 °F)</b> <b>0°C (32 °F)</b> <b>-15°C (5 °F)</b>	<b>102%</b> <b>100%</b> <b>90%</b> <b>70%</b>
<b>Self-Discharge 25°C (77 °F) Capacity</b>	after 3 month storage after 6 month storage after 12 month storage	<b>92%</b> <b>84%</b> <b>65%</b>
<b>Charge (Constant Voltage) 25°C</b>	<b>Standby Use</b>	<b>Initial Charging Current Less than 25.0A</b> <b>Voltage 13.6-13.8V</b>
	<b>Cycle Use</b>	<b>Initial Charging Current Less than 25.0A</b> <b>Voltage 14.4-14.9V</b>